

1

Determine the force in member  $DG$  of the loaded truss.

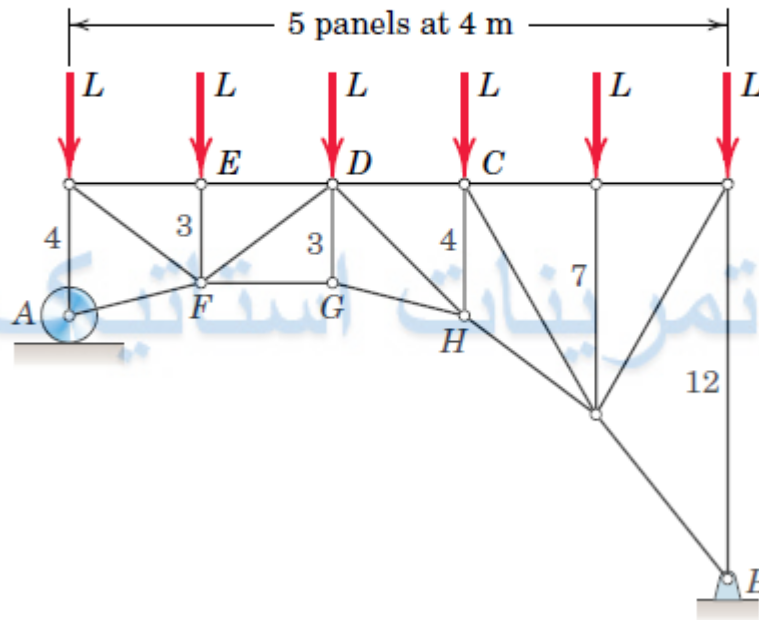

Dimensions in meters

دکتر شاطرزاده

2

Determine the forces in members  $DE$  and  $DL$ .

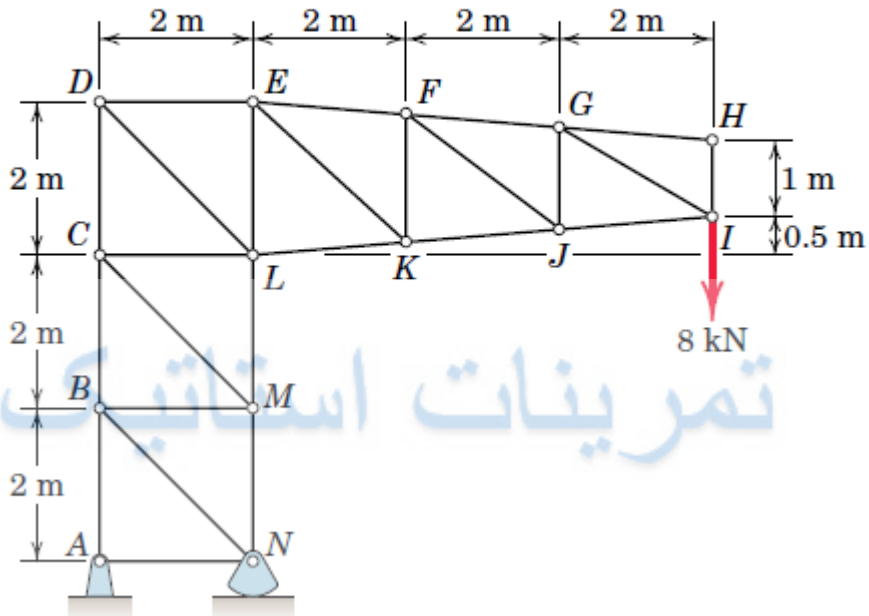

3

The truss shown is composed of  $45^\circ$  right triangles. The crossed members in the center two panels are slender tie rods incapable of supporting compression. Retain the two rods which are under tension and compute the magnitudes of their tensions. Also find the force in member  $MN$ .

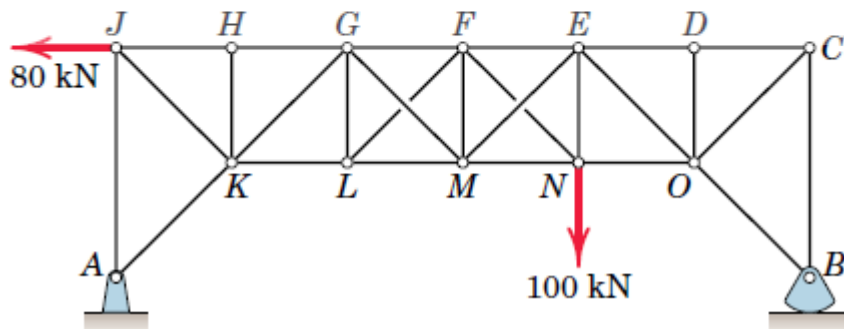

4

The hinged frames  $ACE$  and  $DFB$  are connected by two hinged bars,  $AB$  and  $CD$ , which cross without being connected. Compute the force in  $AB$ .

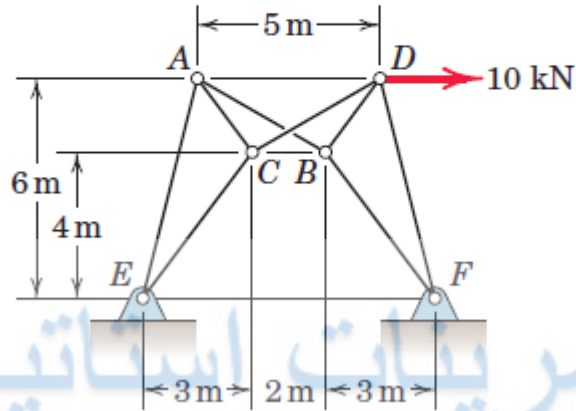

5

Determine the force in member  $CL$  of the loaded truss. The radius of curvature of the upper chord  $BCDEFG$  is 30 m.

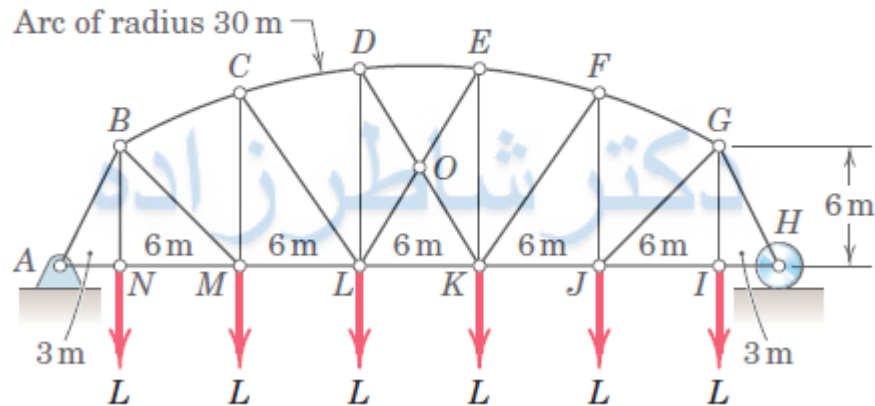

6

Determine the force in member  $DK$  of the loaded overhead sign truss.

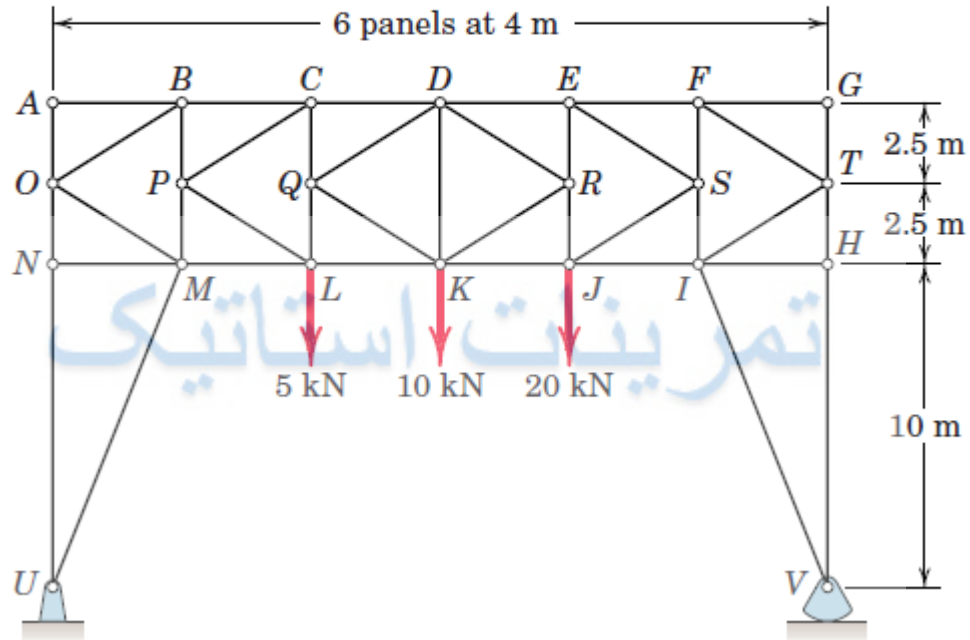

دکتر شاطرزاده